

APN: Right of Way
No APN assigned

Mail Tax Statements to:
Wolfhound Holdings LLC
2711 N. Haskell Ave., Ste 1800
Dallas, Texas 75204

When recorded, return original to:
City of Sparks
P.O. Box 857
Sparks, Nevada 89432-0857
Attn: City Clerk

City of Sparks

ORDER VACATING RIGHT OF WAY

WHEREAS Record of Survey Map No. 1186 was filed in the Official Records of Washoe County, Nevada on June 23, 1978 also being in the NW1/2 of Section 8, Township 19 North, Range 20 East, M. D. B.& M said Record of Survey Map describe streets and alleys as shown thereon dedicated to the City of Sparks, Washoe County, Nevada, and;

WHEREAS a petition has been made to the City to vacate a portion of Victorian Plaza Circle shown on said Record of Survey Map No. 1186 as described in Exhibit "A" and depicted on Exhibit "B", attached hereto and by reference made a part hereof, in accordance with NRS 278.480, and said petition was reviewed by the Sparks City Council following a public hearing held on July 27, 2015, and;

WHEREAS notice was given by certified mail to each owner of property abutting the proposed abandonment, and was published in accordance with NRS 278.480(3), a public hearing was conducted by this Council and as a result of the hearing, the Sparks City Council finds that the public will not be materially injured by the proposed vacation of that portion of Victorian Plaza Circle,

NOW THEREFORE IT BE ORDERED BY THE CITY COUNCIL OF THE CITY OF SPARKS, NEVADA

Section 1. The City of Sparks does hereby VACATE all of its rights regarding the property described in Exhibit "A" and depicted on Exhibit "B", hereto and by reference made a part hereof, TO THE PARTIES LEGALLY ENTITLED THERETO (as provided in NRS 278.480 and other provisions of Nevada law).

Section 2. The officers of the City are hereby authorized and directed to take all action necessary to effectuate the provisions of this resolution and to accomplish its purposes, including the recording of this resolution and order in the official records of Washoe County, Nevada. The City Clerk is hereby authorized to execute any documents intended to accomplish the purposes of this order.

Section 3. If any provision in this resolution and order is deemed invalid or unconstitutional by any court of competent jurisdiction, such offending provision shall be deemed a separate, distinct and independent provision and such holding shall not affect the validity of the remaining provisions herein.

PASSED AND ADOPTED ON THE 27th day of July, 2015

APPROVED this _____ day of July, 2015.

By _____
Geno Martini, Mayor

ATTEST:

APPROVED TO FORM:

By _____
Teresa Gardner
City Clerk

By _____
Shirle Eiting
Sr. Assistant City Attorney



Land Information Solutions

TRI STATE SURVEYING, LTD.

1925 E. Prater Way, Sparks, Nevada 89434

Telephone (775) 358-9491 ♦ FAX (775) 358-3664

Toll Free: 1-800-411-3752

July 10, 2014

Project No. 13124.010.RC

EXHIBIT A

ABANDONMENT VICTORIAN PLAZA CIRCLE

All that certain piece or parcel of land situate within a portion of the Northwest One-Half (N 1/2) of Section Eight (8), Township Nineteen (19) North, Range Twenty (20) East, Mount Diablo Meridian, City of Sparks, Washoe County, Nevada, being a portion of Victorian Plaza Circle as shown on Record of Survey Map No. 1186, filed in the Office of the Washoe County Recorder on June 23, 1978, and being more particularly described as follows:

BEGINNING at a point on the westerly right-of-way line of said Victorian Plaza Circle, from which the Northeast Corner of said Section 8 bears North $80^{\circ}45'19''$ West, 4042.90;

THENCE along said westerly right-of-way line, North $00^{\circ}52'45''$ East, 1.36;

THENCE leaving said westerly right-of-way line, South $44^{\circ}08'35''$ West, 0.96 feet;

THENCE South $45^{\circ}51'25''$ West, 0.96 Feet, to the Point of Beginning for this description;

CONTAINING an area of 0.46 square feet of land, more or less.

BASIS OF BEARINGS:

The basis of bearing for this description is the grid bearing of North $87^{\circ}02'39''$ East between City of Sparks GPS control points 2057 and 2010 using NAD 83/94, Nevada State Plane West Zone, as shown on that "Record of Survey for the City of Sparks 2000 Geodetic Control Network" and recorded as Record of Survey Map No. 3385, File No. 2522263 on February 7, 2001, in Official Records of the County Recorder, Washoe County, Nevada. Grid to Ground Factor = 1.000197939.

Prepared by:

TRI STATE SURVEYING, LTD.

Lee H. Smithson, P.L.S.
Nevada Certificate No. 5097

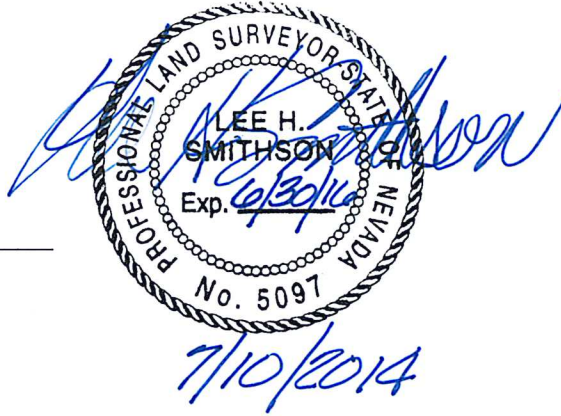

EXHIBIT "B"



**NUGGET
SOUTHEAST
TOWER**
N.T.S.
A.P.N. 032-201-21

T. 19N., R. 20E.
M.D.M



S80°45'19"E 4042.90'
TIE TO SECTION CORNER

N53SM01111 (S2001)
N 14870502.15 (GROUND)
E 2290069.66

N00°52'45"E
1.36'

RIGHT-OF-WAY LINE

S54°08'35"E
0.96'
N45°51'25"E
0.96'

AREA=0.46 SQ.FT. +/-

N 14869852.47
E 2294060.01
(GROUND)

VICTORIAN PLAZA CIR.

EXISTING
BUILDING
LINE

0.40'-BUILDING
ECROACHMENT

BASIS OF BEARINGS

THE GRID BEARING OF S89°24'34"E, BETWEEN CITY OF SPARKS GPS CONTROL POINTS 2001 (N53SM01111) & 2064 (N53SM01114) USING NAD 83/94-HARN, AS SHOWN ON THAT "RECORD OF SURVEY FOR THE CITY OF SPARKS 2000 GEODETIC CONTROL NETWORK" RECORDED AS RECORD OF SURVEY MAP 3885, FILE NO. 2522263, FEBRUARY 7, 2001, OFFICIAL RECORDS OF WASHOE COUNTY, NEVADA.
GRID TO GROUND FACTOR = 1.000197939

TRI STATE SURVEYING, LTD
1925 E. PRATER WAY
SPARKS, NEVADA 89434
(775) 358-9491 FAX 358-3664

EXHIBIT MAP
TO ACCOMPANY
LEGAL DESCRIPTION
OF ABANDONMENT

JOB NO.
13124.01RC

DRAWN BY LHS
CHECKED BY DCC DATE 07-31-2014

SPARKS **NEVADA**

SHEET
1
OF 1